



# QuietTorque™ 30.0LC

Clean, Green, and Quiet!

*Electric propulsion systems engineered and built by sailors for sailors since 2007!*

The **QuietTorque™ 30.0LC** is recommended for boats up to 45' (LOA) and 28,000lbs displacement.

Typically replacing diesel engines up to 60 hp. Typical battery size is 300 – 500Ah

## Specifications

|                   |                                  |
|-------------------|----------------------------------|
| Motor type        | 2 PMAC Brushless (Liquid Cooled) |
| Voltage           | 48Vdc                            |
| Max Input Power   | 30kW                             |
| Cont. Input Power | 25kW                             |
| Weight            | 200 lbs (68 kg)                  |
| Frame             | Anodized Aluminum                |
| Shaft             | Stainless Steel                  |

## Standard Features

|                |  |
|----------------|--|
| Motor Mounts   | Adjustable Mounts to current engine stringers  |
| Throttle       | Anodized Al waterproof throttle with key & neutral lock  |
| System Monitor | Programmable digital display <ul style="list-style-type: none"> <li>• State of Charge (SOC)</li> <li>• Voltage, Current, Power and RPM</li> <li>• Time to Discharge (TTD)</li> <li>• Programmable regeneration and max power</li> <li>• Programmable RH or LH propeller rotation</li> <li>• Programmable for flooded, AGM and LiFePO4 battery type and size</li> </ul> |
| Shaft coupler  | 4" flange (Hurth/Borg Warner)  |
| Power Switch   | Two position GigaVac 500A switch   |
| Relay          | 500A TE Connectivity vacuum relay  |
| Fuse           | Class-T fuse & holder  |

## Why Electric Yacht

- UNPARALLELED CUSTOMER SERVICE AND ENGINEERING
- Computer generated performance projections
- Three year warranty
- Designed for customer installation



The **QuietTorque™ 30.0LC** is a complete and includes everything you will need except batteries, battery cables and charger. Contact us directly or through one of our dealers and we will help you design a complete system to meet your particular needs.

# Application Guide:



## Where is the *QuietTorque™ 30.0* most appropriate?

- Monohull sailboats up to 30,000 lbs replacing diesel engines up to 55hp
- Launches and other displacement mode power boats up to 16000 lbs
- Installations often use portable generator to extend range
- Sailboats for weekend sailing and occasional coastal cruising trips

## Ordering Options:

**Standard throttle and monitor control (+\$0 USD)** is appropriate in most cases. The exposed



metal parts are made of Stainless steel and Al for long life in a marine environment. The unit incorporates a neutral lock to prevent accidental operation. Designed to provide many years of dependable operation.



### **The optional handle style throttle control (+\$200 USD)**

for a more traditional look or a longer reach is needed. Exposed metal parts share the same Stainless steel and Al construction as our standard throttle. The unit incorporates a neutral lock.



### **The optional larger monitor (+\$250 USD)** larger monitor providing larger display and programing functions



### **The optional Binnacle Mount (+\$295 USD)** is

appropriate for boats with wheel steering. It is designed to attach to the 1" grab rail that surrounds most binnacles. It can also attach directly to a binnacle post if no rail is present. It is supplied with longer 20' cables and is ready to install on your binnacle.



### **The optional Current Sensor (+\$195 USD)** is

recommended when a generator and/or solar is used to extend range. The current sensor measures charging current and will give correct State of Charge (SOC) and Time to Discharge (TTD) readings by capturing the power being generated. It is installed between the output of the generator (or generator powered battery charger) and the battery. While not necessary for occasional usage, it is recommended for use with portable generators.



## QuietTorque™ 30.0LC Dimension Data

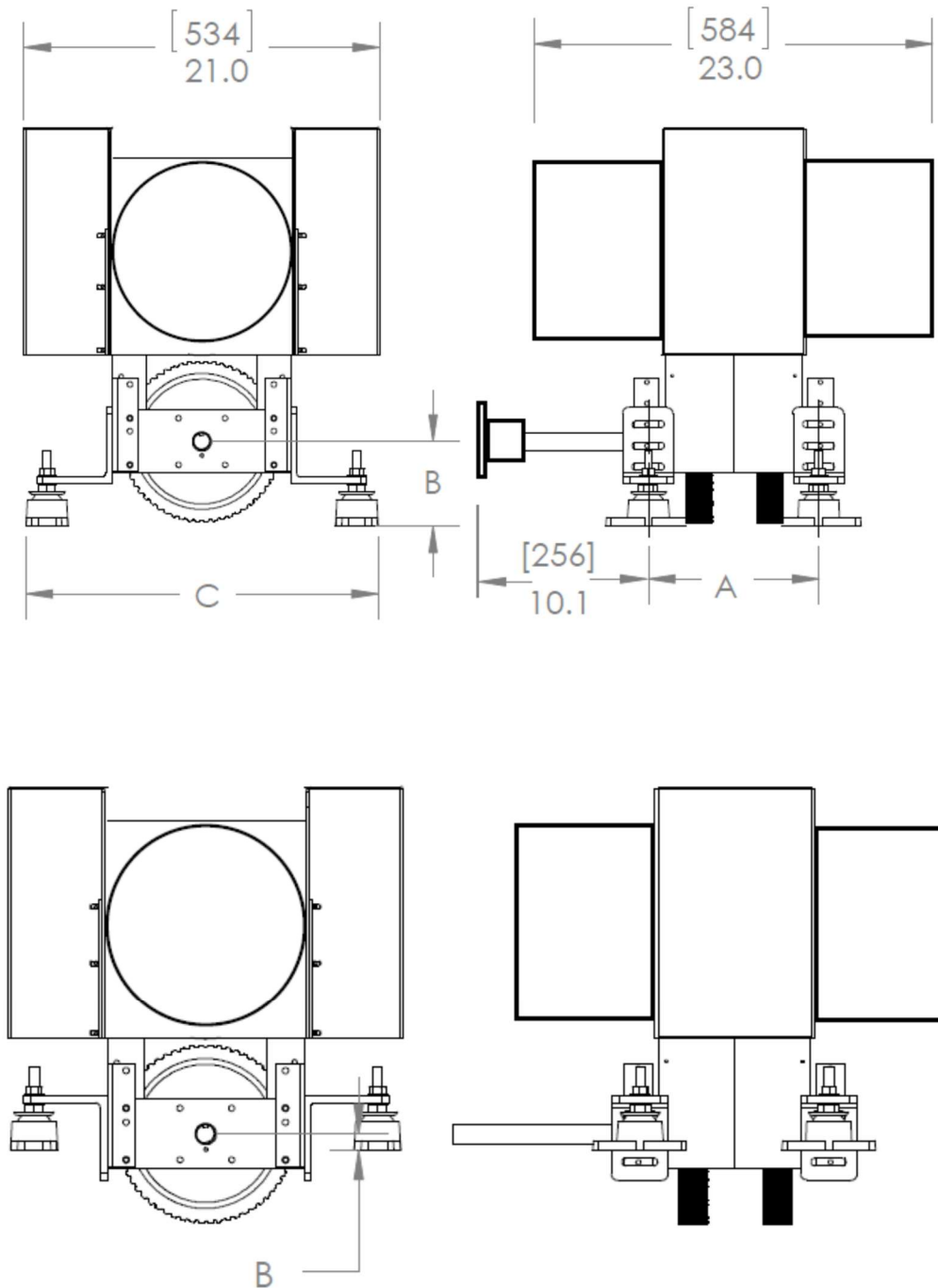

- A) Center Line of Foot to Center Line of Foot 8"(203) Min 11"(279) Max  
 B) Center of Shaft to Above shaft 1.65"(42) to 6.2"(157) Below Shaft  
 C) Outside to Outside of Foot Min 16.4"(416) Max 20.8"(528)