



# QuietTorque™ 45.0LC

Clean, Green, and Quiet!

*Electric propulsion systems engineered  
and built by sailors for sailors since 2007!*

The **QuietTorque™ 45.0LC** is recommended for boats up to 50' (LOA) and 38,000lbs displacement. Typically replacing diesel engines up to 70 hp. Typical battery size is 300 – 500Ah

## Specifications

Motor type	2 PMAC Brushless
Voltage	72Vdc
Max Input Power	45kW
Cont. Input Power	40kW
Weight	200 lbs (68 kg)
Frame	Anodized Aluminum
Shaft	Stainless Steel

## Standard Features

Motor Mounts stringers	Adjustable Mounts to current engine
Throttle neutral lock	Anodized Al waterproof throttle with key & neutral lock
System Monitor	Programmable digital display <ul style="list-style-type: none"> <li>• State of Charge (SOC)</li> <li>• Voltage, Current, Power and RPM</li> <li>• Time to Discharge (TTD)</li> <li>• Programmable regeneration and max power</li> <li>• Programmable RH or LH propeller rotation</li> <li>• Programmable for flooded, AGM and LiFePO4 battery type and size</li> </ul>
Shaft coupler	4" flange (Hurth/Borg Warner)
Power Switch	Two position GigaVac 500A switch
Relay	500A TE Connectivity vacuum relay
Fuse	Class-T fuse & holder



## Why Electric Yacht

- UNPARALLED CUSTOMER SERVICE AND ENGINEERING
- Computer generated performance projections
- Three year warranty
- Designed for customer installation

The **QuietTorque™ 45.0LC** is a complete and includes everything you will need except batteries, battery cables and charger. Contact us directly or through one of our dealers and we will help you design a complete system to meet your particular needs.

## Application Guide:

### Where is the QT 45.0LC most appropriate?

- Monohull sailboats up to 38000 lbs replacing diesel engines up to 60hp
- Multihull sailboats replacing gas/diesel engines up to 70hp
- Launches and other displacement mode power boats up to 30000 lbs
- Installations with or without a diesel generator used to extend range
- Sailboats mostly used for weekend sailing and coastal and offshore cruising

## Ordering Options:

**The new larger monitor (+\$250)** This larger easy to read programable monitor screen is twice the size as the standard monitor. It has an expanded second screen with motor data presented in a clear and easy to read format.



### The optional handle style throttle control

**(+\$200 USD)** is appropriate when a more traditional look is desired or when a longer reach is needed. The exposed metal parts share the same nickel plated aluminum construction as our standard throttle control. The unit incorporates a

neutral lock to prevent accidental operation.



**The Binnacle Mount – now in white (+\$295 USD)** is appropriate for boats with wheel steering. It is designed to attach to the 1" grab rail that surrounds most binnacles. It can also attach directly to a binnacle post if no rail is present. It is supplied with longer 20' cables and is ready to install on your binnacle.



**The Current Sensor (+\$195 USD)** is recommended when a generator and/or solar is used to extend range. The current sensor measures charging current and will give correct State of Charge (SOC) and Time To Discharge (TTD) readings by capturing the power being generated. It is installed between the output of the generator (or generator powered battery charger) and the battery.

While not necessary for occasional usage, it is recommended for use with portable generators.



## QT45.0LC Dimension Data

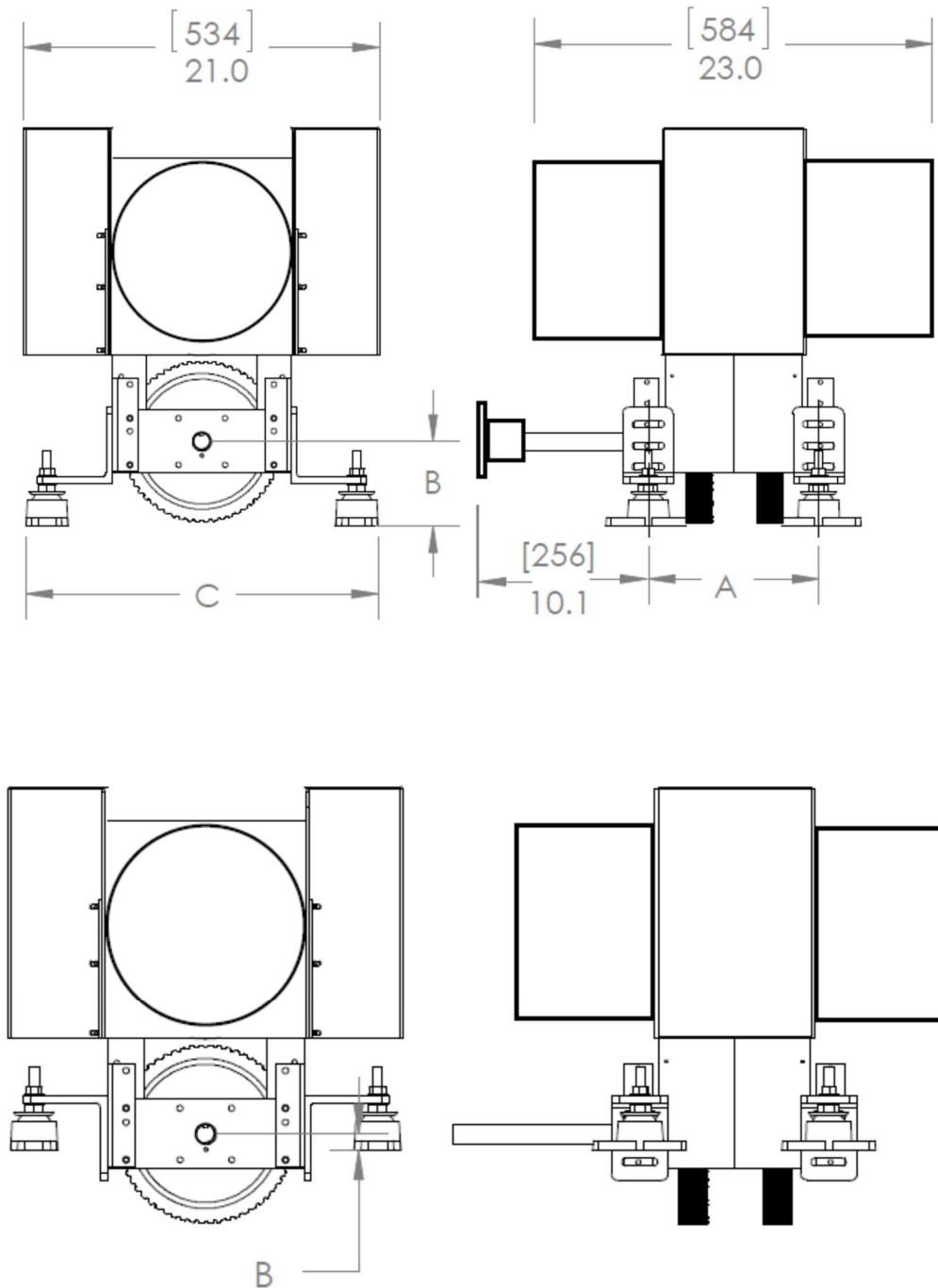

- A) Center Line of Foot to Center Line of Foot 8"(203) Min 11"(279) Max
- B) Center of Shaft to Above shaft 1.65"(42) to 6.2"(157) Below Shaft
- C) Outside to Outside of Foot Min 16.4"(416) Max 20.8"(528)